

# LF 3800/LF 3900 Push-In Fittings Range

## Stud Fittings

### Straights

**3805**  
**3905**  
BSPT  
Page 1-115



**3805**  
NPT  
Page 1-115



**3801**  
**3901**  
BSPP/Metric  
Page 1-115



**3821**  
**3921**  
BSPT  
Page 1-116



**3821**  
**3921**  
NPT  
Page 1-116



**3831**  
**3931**  
BSPP/Metric  
Page 1-116



**3800**  
**3900**  
Page 1-117



### Straights - Inch

**3805**  
NPT  
Page 1-115



**3821**  
NPT  
Page 1-116



### Elbows

**3809**  
**3909**  
BSPT  
Page 1-117



**3809**  
NPT  
Page 1-117



**3899**  
**3999**  
BSPP/Metric  
Page 1-117



**3889**  
**3989**  
BSPT  
Page 1-118



**3889**  
NPT  
Page 1-118



**3879**  
**3979**  
BSPP  
Page 1-118



**3889**  
NPT  
Page 1-118



### Elbow - Inch

### Tees

**3803**  
**3903**  
BSPT  
Page 1-119



**3803**  
NPT  
Page 1-119



**3893**  
**3993**  
BSPP/Metric  
Page 1-119



**3808**  
**3908**  
BSPT  
Page 1-119



**3808**  
NPT  
Page 1-120



**3898**  
**3998**  
BSPP/Metric  
Page 1-120



## Tube-to-Tube Fittings

### Straight

**3806**  
**3906**  
Page 1-121



### Straight - Inch

**3806**  
**3906**  
Page 1-121



### Elbow

**3802**  
**3902**  
Page 1-121



### Elbow - Inch

**3802**  
**3902**  
Page 1-121



### Tee

**3804**  
**3904**  
Page 1-121



### Tee - Inch

**3804**  
Page 1-122



## Bulkhead Connector Fittings

### Straight

**3816**  
**3916**  
Page 1-122



### Straight - Inch

**3816**  
**3916**  
Page 1-122



## Plug-In Fittings and Accessories

**3866**  
**3966**  
Reducer  
Page 1-123



**3826**  
Plug  
Page 1-123



## Accessories

**3800 70**  
Page 1-123

**0605**  
Page 1-123

**3000 70**  
Page 1-123



# LF 3800/LF 3900 Push-In Fittings

Parker Legris has developed two ranges of **stainless steel fittings (LF 3800 or LF 3900 in full 316L)** for conveying corrosive fluids in **aggressive environments**. These ranges provide two complementary levels of corrosion resistance and a **hygienic external design**.

## Product Advantages

### High Resistance to Aggressive Environments

LF 3800: excellent for conveying aggressive fluids  
 LF 3900: maximum chemical resistance to internal and external corrosion  
 Hygienic external design for reducing retention zones  
 Easy cleaning in situ  
 Proven gripping technology

### Wide Range of Applications

Perfect for permanent contact with foodstuffs  
 Compatible with frequent sterilization  
 Excellent in saline environments and outdoor applications  
 Resistant to industrial cleaning agents and detergents  
 Compatible with polymer and grooved stainless steel tubing  
 One fitting for many applications: optimised stock management

### Reliability & Safety

All-metal product allowing detection of all components  
 Full bore, with minimal pressure drop  
 Resistant to hammering, mechanical shock and impulse  
 Manual connection and disconnection, no tools required  
 100% leak-tested in production  
 Date coding to guarantee quality and traceability  
 IP 51 bulkhead: complete protection against ingress in food and non-food zones



**Applications**

Food Process  
 Paper Industry  
 Petrochemical  
 Pharmaceutical  
 Chemical  
 Medical

## Technical Characteristics

<b>Compatible Fluids</b>	All fluids compatible with the fitting and tubing component materials					
<b>Working Pressure</b>	Vacuum to 30 bar (20 bar: 3879/3979 and 3889/3989)					
<b>Working Temperature</b>	-25° to +150°C					

<b>Adaptor Tightening Torque</b>	Threads	M5x0.8	G1/8	G1/4	G3/8	G1/2
	daN.m	0.16	0.8	1.2	3	3.5
<b>Bulkhead Tightening Torque</b>	Ø (mm)	4	6	8	10	12
	daN.m min. max.	0.5 0.9	0.5 0.9	0.6 1	0.6 1	0.6 1

Reliable performance is dependent upon the type of fluid conveyed, component materials and tubing being used.  
 Use is guaranteed with a vacuum of 755 mm Hg (99% vacuum).  
 Technical performance tested at -25°C according to the ISO 14743 standard.

### Component Materials

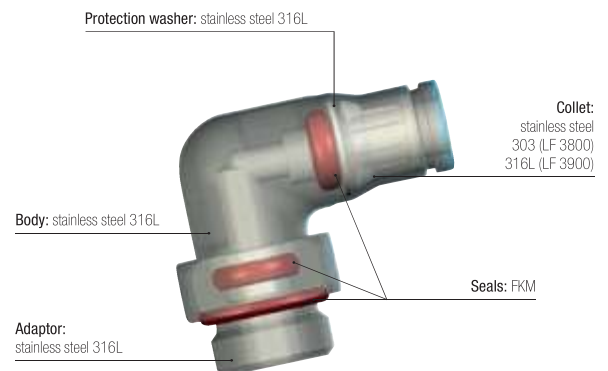

### Silicone-free

### Regulations

ISO 14743 Pneumatic transmissions, push-in fittings for thermoplastic tubing  
 EN 45545-2 HL3, R22, R24, R25 classification can be attained when used with fireproof tubing  
 DI: 97/23/EC (PED)  
 DI: 2002/95/EC (RoHS), 2011/65/EC

DI: 94/9/EC (ATEX)  
 RG: 1907/2006 (REACH)  
 UL94 V-0: Seal  
 RG: 21CFR (FDA)  
 RG: 1935/2004/EC  
 USDA NSF H1: Grease

# Stud Fittings

## 3805/3905 Stud Fitting, Male BSPT Thread



Stainless steel 316L, FKM

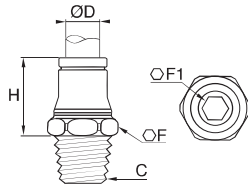

ØD	C			F	F1	H	Kg
4	R1/8	<a href="#">3805 04 10</a>	<a href="#">3905 04 10</a>	10	3	14.5	0.008
	R1/4	<a href="#">3805 04 13</a>	<a href="#">3905 04 13</a>	14	3	14.5	0.016
6	R1/8	<a href="#">3805 06 10</a>	<a href="#">3905 06 10</a>	13	4	18	0.012
	R1/4	<a href="#">3805 06 13</a>	<a href="#">3905 06 13</a>	14	4	16.5	0.018
8	R1/8	<a href="#">3805 08 10</a>	<a href="#">3905 08 10</a>	15	5	19	0.014
	R1/4	<a href="#">3805 08 13</a>	<a href="#">3905 08 13</a>	15	6	18	0.018
10	R3/8	<a href="#">3805 08 17</a>	<a href="#">3905 08 17</a>	17	6	18.5	0.025
	R1/4	<a href="#">3805 10 13</a>	<a href="#">3905 10 13</a>	19	6	24	0.029
	R3/8	<a href="#">3805 10 17</a>	<a href="#">3905 10 17</a>	19	6	22.5	0.030
	R1/4	<a href="#">3805 12 13</a>	<a href="#">3905 12 13</a>	22	7	25	0.034
12	R3/8	<a href="#">3805 12 17</a>	<a href="#">3905 12 17</a>	22	8	24	0.038
	R1/2	<a href="#">3805 12 21</a>	<a href="#">3905 12 21</a>	22	10	23	0.046

## 3805 Stud Fitting, Male NPT Thread



Stainless steel 316L, FKM

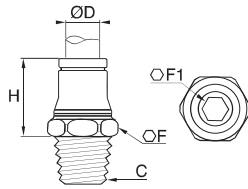

ØD	C		F	F1	H	Kg
4	NPT1/8	<a href="#">3805 04 11</a>	11	3	14.5	0.009
6	NPT1/8	<a href="#">3805 06 11</a>	13	4	18	0.012
	NPT1/4	<a href="#">3805 06 14</a>	14	4	16.5	0.017
8	NPT1/8	<a href="#">3805 08 11</a>	15	5	19	0.015
	NPT1/4	<a href="#">3805 08 14</a>	15	6	18	0.018
10	NPT1/4	<a href="#">3805 10 14</a>	19	6	24	0.028
	NPT3/8	<a href="#">3805 10 18</a>	19	7	22.5	0.031
12	NPT1/4	<a href="#">3805 12 14</a>	22	7	25	0.035
	NPT3/8	<a href="#">3805 12 18</a>	22	8	24	0.039
	NPT1/2	<a href="#">3805 12 22</a>	22	10	23	0.045

## 3805 Stud Fitting, Male NPT Thread



Inch

Stainless steel 316L, FKM

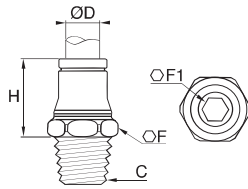

ØD	C		F	F1	H	Kg
3/16	NPT1/8	<a href="#">3805 55 11</a>	10	3	15.5	0.011
	NPT1/4	<a href="#">3805 55 14</a>	14	3	15.5	0.016
1/4	NPT1/8	<a href="#">3805 56 11</a>	13	4	19	0.012
	NPT1/4	<a href="#">3805 56 14</a>	14	4	17.5	0.018
3/8	NPT1/4	<a href="#">3805 60 14</a>	19	6	25	0.029
	NPT3/8	<a href="#">3805 60 18</a>	19	7	24	0.032
1/2	NPT1/4	<a href="#">3805 62 14</a>	22	7	26	0.036
	NPT3/8	<a href="#">3805 62 18</a>	22	8	25	0.041
	NPT1/2	<a href="#">3805 62 22</a>	22	10	25	0.050

5/32" (4 mm) and 5/16" (8 mm) also available

## 3801/3901 Stud Fitting, Male BSPP and Metric Thread



Stainless steel 316L, FKM

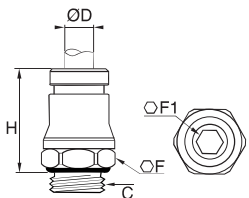

ØD	C			F	F1	H	Kg
4	M5x0.8	<a href="#">3801 04 19</a>	<a href="#">3901 04 19</a>	10	2.5	17	0.005
	G1/8	<a href="#">3801 04 10</a>	<a href="#">3901 04 10</a>	13	3	16.5	0.009
	M5x0.8	<a href="#">3801 06 19</a>	<a href="#">3901 06 19</a>	13	2.5	20.5	0.010
6	G1/8	<a href="#">3801 06 10</a>	<a href="#">3901 06 10</a>	13	4	18	0.010
	G1/4	<a href="#">3801 06 13</a>	<a href="#">3901 06 13</a>	17	4	18	0.015
	G1/8	<a href="#">3801 08 10</a>	<a href="#">3901 08 10</a>	15	5	19	0.013
8	G1/4	<a href="#">3801 08 13</a>	<a href="#">3901 08 13</a>	17	5	20.5	0.017
	G3/8	<a href="#">3801 08 17</a>	<a href="#">3901 08 17</a>	21	6	20	0.027
10	G1/4	<a href="#">3801 10 13</a>	<a href="#">3901 10 13</a>	19	7	25	0.025
	G3/8	<a href="#">3801 10 17</a>	<a href="#">3901 10 17</a>	21	7	25	0.035
12	G1/4	<a href="#">3801 12 13</a>	<a href="#">3901 12 13</a>	21	7	27	0.030
	G3/8	<a href="#">3801 12 17</a>	<a href="#">3901 12 17</a>	21	9	26.5	0.034

Other products are available upon request; please do not hesitate to consult us.

# Stud Fittings

## 3821/3921 Stud Standpipe, Male BSPT Thread



Stainless steel 316L

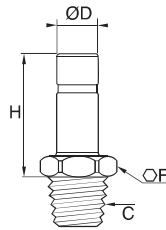

ØD	C			F	H	Kg
4	R1/8	<a href="#">3821 04 10</a>	<a href="#">3921 04 10</a>	10	21	0.006
	R1/4	<a href="#">3821 06 10</a>	<a href="#">3921 06 10</a>	10	23	0.007
6	R1/8	<a href="#">3821 06 13</a>	<a href="#">3921 06 13</a>	14	24	0.015
	R1/4	<a href="#">3821 08 10</a>	<a href="#">3921 08 10</a>	11	24	0.008
8	R1/4	<a href="#">3821 08 13</a>	<a href="#">3921 08 13</a>	14	25	0.016
	R1/4	<a href="#">3821 10 13</a>	<a href="#">3921 10 13</a>	19	30	0.017
10	R3/8	<a href="#">3821 10 17</a>	<a href="#">3921 10 17</a>	19	30	0.022
	R1/4	<a href="#">3821 12 13</a>	<a href="#">3921 12 13</a>	19	31	0.018
12	R3/8	<a href="#">3821 12 17</a>	<a href="#">3921 12 17</a>	19	31	0.022
	R1/2	<a href="#">3821 12 21</a>	<a href="#">3921 12 21</a>	22	32	0.040

## 3821/3921 Stud Standpipe, Male NPT Thread



Stainless steel 316L

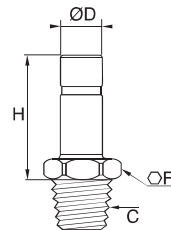

ØD	C			F	H	Kg
4	NPT1/8	<a href="#">3821 04 11</a>	<a href="#">3921 04 11</a>	10	21	0.006
	NPT1/4	<a href="#">3821 06 11</a>	<a href="#">3921 06 11</a>	10	23	0.007
6	NPT1/8	<a href="#">3821 06 14</a>	<a href="#">3921 06 14</a>	14	24	0.016
	NPT1/4	<a href="#">3821 08 11</a>	<a href="#">3921 08 11</a>	14	24	0.010
8	NPT1/4	<a href="#">3821 08 14</a>	<a href="#">3921 08 14</a>	14	25	0.016
	NPT1/4	<a href="#">3821 10 14</a>	<a href="#">3921 10 14</a>	14	30	0.017
10	NPT3/8	<a href="#">3821 10 18</a>	<a href="#">3921 10 18</a>	17	30	0.010
	NPT1/4	<a href="#">3821 12 14</a>	<a href="#">3921 12 14</a>	14	31	0.018
12	NPT3/8	<a href="#">3821 12 18</a>	<a href="#">3921 12 18</a>	17	31	0.026
	NPT1/2	<a href="#">3821 12 22</a>	<a href="#">3921 12 22</a>	22	32	0.050

## 3821 Stud Standpipe, Male NPT Thread



Inch

Stainless steel 316L

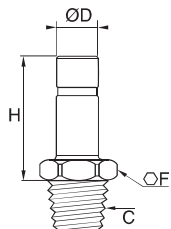

ØD	C			F	H	Kg
3/16	NPT1/8	<a href="#">3821 55 11</a>		10	25	0.009
1/4	NPT1/8	<a href="#">3821 56 11</a>		10	26	0.009
	NPT1/4	<a href="#">3821 56 14</a>		14	27	0.016
3/8	NPT1/4	<a href="#">3821 60 14</a>		19	32	0.019
	NPT3/8	<a href="#">3821 60 18</a>		19	32	0.029
1/2	NPT1/4	<a href="#">3821 62 14</a>		19	36	0.033
	NPT3/8	<a href="#">3821 62 18</a>		19	37	0.025
	NPT1/2	<a href="#">3821 62 22</a>		22	37	0.042

5/32"(4 mm) and 5/16"(8 mm) also available

## 3831/3931 Stud Standpipe, Male BSPP and Metric Thread



Stainless steel 316L, FKM

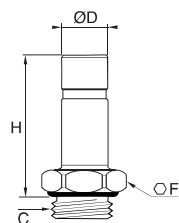

ØD	C			F	H	K	Kg
	M5x0.8	<a href="#">3831 04 19</a>	<a href="#">3931 04 19</a>	7	23.5	8	0.004
4	G1/8	<a href="#">3831 04 10</a>	<a href="#">3931 04 10</a>	13	22	14	0.008
	G1/4	<a href="#">3831 04 13</a>	<a href="#">3931 04 13</a>	17	22	18.5	0.016
6	G1/8	<a href="#">3831 06 10</a>	<a href="#">3931 06 10</a>	13	24	14	0.009
	G1/4	<a href="#">3831 06 13</a>	<a href="#">3931 06 13</a>	17	24	18.5	0.015
8	G1/8	<a href="#">3831 08 10</a>	<a href="#">3931 08 10</a>	13	25	14	0.010
	G1/4	<a href="#">3831 08 13</a>	<a href="#">3931 08 13</a>	17	27	18.5	0.019
10	G3/8	<a href="#">3831 08 17</a>	<a href="#">3931 08 17</a>	21	27	23	0.024
	G1/4	<a href="#">3831 10 13</a>	<a href="#">3931 10 13</a>	17	32	18.5	0.020
12	G3/8	<a href="#">3831 10 17</a>	<a href="#">3931 10 17</a>	21	27	23	0.025
	G1/4	<a href="#">3831 12 13</a>	<a href="#">3931 12 13</a>	17	33	18.5	0.021
12	G3/8	<a href="#">3831 12 17</a>	<a href="#">3931 12 17</a>	21	33	23	0.028
	G1/2	<a href="#">3831 12 21</a>	<a href="#">3931 12 21</a>	24	36	26	0.043

LF 3800 : 316L stainless steel (body) with 303 stainless steel collet, FKM seals  
 LF 3900 : full 316L, FKM seals

# Stud Fittings

## 3800/3900 One-Piece Cartridge



Stainless steel 316L, FKM

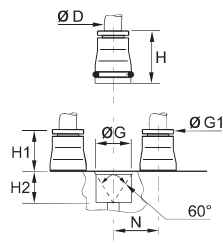

ØD			G	G1	H	H1	H2	N	Kg
4	<a href="#">3800 04 00</a>	<a href="#">3900 04 00</a>	9.8	8	17	8.5	8.5	11	0.006
6	<a href="#">3800 06 00</a>	<a href="#">3900 06 00</a>	12.1	10	19	10.5	8.5	13.5	0.008
8	<a href="#">3800 08 00</a>	<a href="#">3900 08 00</a>	14.8	13	21	12.5	8.5	16	0.012
10	<a href="#">3800 10 00</a>	<a href="#">3900 10 00</a>	17.5	15	24.5	14	10.5	20	0.019
12	<a href="#">3800 12 00</a>	<a href="#">3900 12 00</a>	20	17	25	14.5	10.5	22.5	0.022

3800: collet in stainless steel 303  
 3900: collet in stainless steel 316L  
 Cavity dimensions are available in chapter 2.

## 3809/3909 Stud Elbow, Male BSPT Thread



Stainless steel 316L, FKM

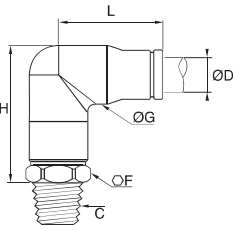

ØD	C			F	G	H	L	Kg
4	R1/8	<a href="#">3809 04 10</a>	<a href="#">3909 04 10</a>	10	10	23.5	16.5	0.020
	R1/4	<a href="#">3809 06 10</a>	<a href="#">3909 06 10</a>	13	12	27.5	20	0.031
6	R1/8	<a href="#">3809 06 13</a>	<a href="#">3909 06 13</a>	14	12	27.5	25	0.036
	R1/4	<a href="#">3809 08 10</a>	<a href="#">3909 08 10</a>	14	15	32	25	0.040
8	R1/8	<a href="#">3809 08 13</a>	<a href="#">3909 08 13</a>	14	14.5	34	25	0.045
	R1/4	<a href="#">3809 10 13</a>	<a href="#">3909 10 13</a>	19	17.5	37.5	27.5	0.069
10	R3/8	<a href="#">3809 10 17</a>	<a href="#">3909 10 17</a>	19	17.5	37.5	27.5	0.070

The body swivels for positioning purposes.

## 3809 Stud Elbow, Male NPT Thread



Stainless steel 316L, FKM

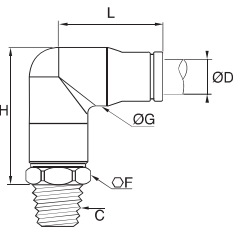

ØD	C			F	G	H	L	Kg
4	NPT1/8	<a href="#">3809 04 11</a>		11	10	25.5	18.5	0.021
	NPT1/8	<a href="#">3809 06 11</a>		13	12.5	29	22.5	0.031
6	NPT1/4	<a href="#">3809 06 14</a>		14	12.5	29	22.5	0.036
	NPT1/8	<a href="#">3809 08 11</a>		14	15	34	24	0.040
8	NPT1/4	<a href="#">3809 08 14</a>		14	15	34	24	0.045
	NPT1/4	<a href="#">3809 10 14</a>		19	17.5	39.5	30	0.068
10	NPT3/8	<a href="#">3809 10 18</a>		19	17.5	39.5	30	0.071

The body swivels for positioning purposes.

## 3899/3999 Stud Elbow, Male BSPP and Metric Thread



Stainless steel 316L, FKM

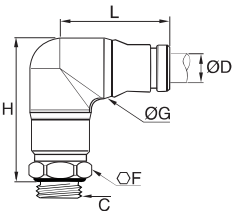

ØD	C			F	G	H	L	Kg
4	M5x0.8	<a href="#">3899 04 19</a>	<a href="#">3999 04 19</a>	10	10	26	18	0.020
	G1/8	<a href="#">3899 04 10</a>	<a href="#">3999 04 10</a>	13	10	27	19	0.022
	G1/4	<a href="#">3899 04 13</a>	<a href="#">3999 04 13</a>	17	10	27	19	0.018
6	M5x0.8	<a href="#">3899 06 19</a>	<a href="#">3999 06 19</a>	13	12	33	24	0.031
	G1/8	<a href="#">3899 06 10</a>	<a href="#">3999 06 10</a>	6	12	33	24	0.031
	G1/4	<a href="#">3899 06 13</a>	<a href="#">3999 06 13</a>	17	12	32	24	0.036
8	G1/8	<a href="#">3899 08 10</a>	<a href="#">3999 08 10</a>	14	15	35	25	0.039
	G1/4	<a href="#">3899 08 13</a>	<a href="#">3999 08 13</a>	17	15	35	25	0.044
	G3/8	<a href="#">3899 08 17</a>	<a href="#">3999 08 17</a>	21	15	34.5	25	0.049
10	G1/4	<a href="#">3899 10 13</a>	<a href="#">3999 10 13</a>	19	17	43	31	0.067
	G3/8	<a href="#">3899 10 17</a>	<a href="#">3999 10 17</a>	21	17	42	31	0.072

The body swivels for positioning purposes.

Stud standpipe 3821, 3921, 3831, 3931 can be used as illustrated, allowing:

- stock optimisation
- installation of tees and elbows where required

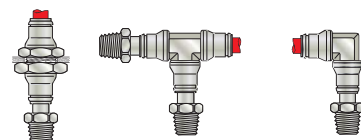

# Stud Fittings

## 3889/3989

### Compact Stud Elbow, Male BSPT Thread



Stainless steel 316L, FKM

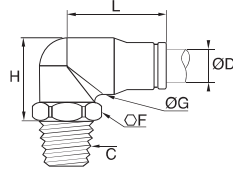

ØD	C			F	G	H	L	Kg
4	R1/8	<a href="#">3889 04 10</a>	<a href="#">3989 04 10</a>	13	10	18	17	0.019
	R1/4	<a href="#">3889 04 13</a>	<a href="#">3989 04 13</a>	17	10	19.5	16.5	0.018
6	R1/8	<a href="#">3889 06 10</a>	<a href="#">3989 06 10</a>	13	12	21.5	20.5	0.026
	R1/4	<a href="#">3889 06 13</a>	<a href="#">3989 06 13</a>	14	12	21.5	20.5	0.032
8	R1/8	<a href="#">3889 08 10</a>	<a href="#">3989 08 10</a>	14	15	24	22	0.035
	R1/4	<a href="#">3889 08 13</a>	<a href="#">3989 08 13</a>	14	15	24	22	0.035
10	R1/4	<a href="#">3889 10 13</a>	<a href="#">3989 10 13</a>	17	17.5	28.5	27.5	0.057
	R3/8	<a href="#">3889 10 17</a>	<a href="#">3989 10 17</a>	19	17.5	28.5	27.5	0.067
12	R1/4	<a href="#">3889 12 13</a>	<a href="#">3989 12 13</a>	22	20	33.5	30	0.088
	R3/8	<a href="#">3889 12 17</a>	<a href="#">3989 12 17</a>	22	20	33.5	30	0.090
	R1/2	<a href="#">3889 12 21</a>	<a href="#">3989 12 21</a>	22	20	33.5	33	0.097

The body swivels for positioning purposes.  
Max. 20 bar

## 3889

### Compact Male Stud Elbow, Male NPT Thread



Stainless steel 316L, FKM

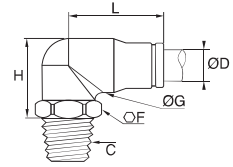

ØD	C		F	G	H	L	Kg
4	NPT1/8	<a href="#">3889 04 11</a>	13	10	17.5	19	0.020
6	NPT1/8	<a href="#">3889 06 11</a>	13	12.5	20	22.5	0.026
	NPT1/4	<a href="#">3889 06 14</a>	14	12.5	20	22.5	0.034
8	NPT1/8	<a href="#">3889 08 11</a>	13	15	25	24	0.035
	NPT1/4	<a href="#">3889 08 14</a>	14	15	24	24	0.036
10	NPT1/4	<a href="#">3889 10 14</a>	17	17.5	27.5	27.5	0.059
	NPT3/8	<a href="#">3889 10 18</a>	19	17.5	28.5	26.5	0.067
12	NPT1/4	<a href="#">3889 12 14</a>	22	20	31.5	32.5	0.086
	NPT3/8	<a href="#">3889 12 18</a>	22	20	32.5	32.5	0.089
	NPT1/2	<a href="#">3889 12 22</a>	22	20	27.5	32.5	0.098

The body swivels for positioning purposes.  
Max. 20 bar

## 3889

### Compact Stud Elbow, Male NPT Thread



Inch

Stainless steel 316L, FKM

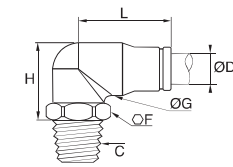

ØD	C		F	G	H	L	Kg
3/16	NPT1/8	<a href="#">3889 55 11</a>	10	10	21	20	0.020
	NPT1/4	<a href="#">3889 55 14</a>	14	10	21	20	0.025
1/4	NPT1/8	<a href="#">3889 56 11</a>	13	12	22	23	0.025
	NPT1/4	<a href="#">3889 56 14</a>	14	12	22	23	0.033
3/8	NPT1/4	<a href="#">3889 60 14</a>	17	17.5	28	30.5	0.059
	NPT3/8	<a href="#">3889 60 18</a>	19	17.5	28	30.5	0.067
1/2	NPT1/4	<a href="#">3889 62 14</a>	22	20	34	33	0.089
	NPT3/8	<a href="#">3889 62 18</a>	22	20	34	33	0.089
1/2	NPT1/2	<a href="#">3889 62 22</a>	22	20	27	33	0.091

The body swivels for positioning purposes.  
5/32" (4 mm) and 5/16" (8 mm) also available.  
Max. 20 bar

## 3879/3979

### Compact Stud Elbow, Male BSPP Thread



FKM, stainless steel 316L

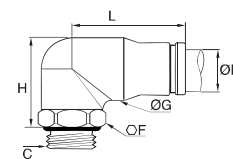

ØD	C			F	G	H	L	Kg
4	G1/8	<a href="#">3879 04 10</a>	<a href="#">3979 04 10</a>	10	11	22	19	0.021
	G1/4	<a href="#">3879 04 13</a>	<a href="#">3979 04 13</a>	17	11	20	19	0.027
6	G1/8	<a href="#">3879 06 10</a>	<a href="#">3979 06 10</a>	13	12	24	24	0.029
	G1/4	<a href="#">3879 06 13</a>	<a href="#">3979 06 13</a>	17	12	22	24	0.034
8	G1/8	<a href="#">3879 08 10</a>	<a href="#">3979 08 10</a>	13	15	25	25	0.035
	G3/8	<a href="#">3879 08 17</a>	<a href="#">3979 08 17</a>	17	15	25	25	0.039
10	G1/4	<a href="#">3879 10 13</a>	<a href="#">3979 10 13</a>	18	17	43	31	0.058
	G3/8	<a href="#">3879 10 17</a>	<a href="#">3979 10 17</a>	21	17	40	31	0.066
12	G1/4	<a href="#">3879 12 13</a>	<a href="#">3979 12 13</a>	17	20	33	33	0.077
	G3/8	<a href="#">3879 12 17</a>	<a href="#">3979 12 17</a>	21	20	33	33	0.082
12	G1/2	<a href="#">3879 12 21</a>	<a href="#">3979 12 21</a>	24	20	30	33	0.097

The body swivels for positioning purposes.  
Max. 20 bar



# Stud Fittings

## 3803/3903 Stud Run Tee, Male BSPT Thread



Stainless steel 316L, FKM

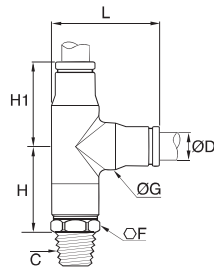

ØD	C			F	G	H	H1	L	Kg
4	R1/8	<a href="#">3803 04 10</a>	<a href="#">3903 04 10</a>	10	10	19	17	22	0.020
6	R1/8	<a href="#">3803 06 10</a>	<a href="#">3903 06 10</a>	13	12	22	20	26.5	0.038
	R1/4	<a href="#">3803 06 13</a>	<a href="#">3903 06 13</a>	14	15	22	20	27	0.035
8	R1/8	<a href="#">3803 08 10</a>	<a href="#">3903 08 10</a>	14	15	24	23	31	0.049
	R1/4	<a href="#">3803 08 13</a>	<a href="#">3903 08 13</a>	14	15	24	23	31	0.055
10	R1/4	<a href="#">3803 10 13</a>	<a href="#">3903 10 13</a>	19	17.5	30	29	38	0.070
	R3/8	<a href="#">3803 10 17</a>	<a href="#">3903 10 17</a>	19	17.5	30	29	38	0.083

The body swivels for positioning purposes.

## 3803 Stud Run Tee, Male NPT Thread



Stainless steel 316L, FKM

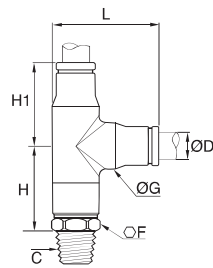

ØD	C			F	G	H	H1	L	Kg
4	NPT1/8	<a href="#">3803 04 11</a>		11	10	21	19	25	0.021
6	NPT1/8	<a href="#">3803 06 11</a>		13	12	24	21	27	0.038
	NPT1/4	<a href="#">3803 06 14</a>		14	12	24	21	27.5	0.037
8	NPT1/8	<a href="#">3803 08 11</a>		14	15	26.5	24	30.5	0.050
	NPT1/4	<a href="#">3803 08 14</a>		14	15	26.5	24	30.5	0.048
10	NPT1/4	<a href="#">3803 10 14</a>		19	17.5	31	29.5	37.5	0.082

The body swivels for positioning purposes.

## 3893/3993 Stud Run Tee, Male BSPP and Metric Thread



Stainless steel 316L, FKM

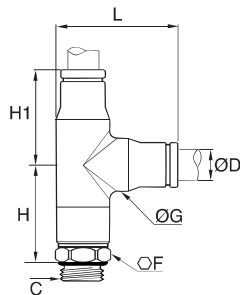

ØD	C			F	G	H	H1	L	Kg
4	M5x0.8	<a href="#">3893 04 19</a>	<a href="#">3993 04 19</a>	10	11	21.5	19	24.5	0.023
	G1/8	<a href="#">3893 04 10</a>	<a href="#">3993 04 10</a>	13	11	21.5	19	24.5	0.026
	G1/4	<a href="#">3893 04 13</a>	<a href="#">3993 04 13</a>	17	11	22	19	28	0.033
6	G1/8	<a href="#">3893 06 10</a>	<a href="#">3993 06 10</a>	13	12	26.5	24	30	0.038
	G1/4	<a href="#">3893 06 13</a>	<a href="#">3993 06 13</a>	17	12	26	24	32	0.043
8	G1/8	<a href="#">3893 08 10</a>	<a href="#">3993 08 10</a>	14	15	27.5	25	32	0.049
	G3/8	<a href="#">3893 08 17</a>	<a href="#">3993 08 17</a>	17	15	28	25	33.5	0.053
10	G1/4	<a href="#">3893 10 13</a>	<a href="#">3993 10 13</a>	19	17	34	31	39	0.081
	G3/8	<a href="#">3893 10 17</a>	<a href="#">3993 10 17</a>	21	17	35.5	31	39.5	0.082

The body swivels for positioning purposes.

## 3808/3908 Stud Branch Tee, Male BSPT Thread



Stainless steel 316L, FKM

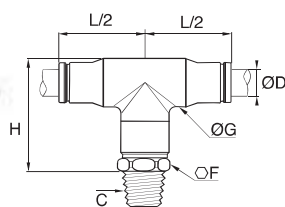

ØD	C			F	G	H	L/2	Kg
4	R1/8	<a href="#">3808 04 10</a>	<a href="#">3908 04 10</a>	10	10	23.5	19	0.020
6	R1/8	<a href="#">3808 06 10</a>	<a href="#">3908 06 10</a>	13	12	27.5	24	0.038
	R1/4	<a href="#">3808 06 13</a>	<a href="#">3908 06 13</a>	14	12	27.5	24	0.044
8	R1/8	<a href="#">3808 08 10</a>	<a href="#">3908 08 10</a>	14	15	32	25	0.049
	R1/4	<a href="#">3808 08 13</a>	<a href="#">3908 08 13</a>	14	15	32	25	0.055
10	R3/8	<a href="#">3808 08 17</a>	<a href="#">3908 08 17</a>	19	15	33	25	0.068
	R1/4	<a href="#">3808 10 13</a>	<a href="#">3908 10 13</a>	19	17.5	37.5	31	0.082
	R3/8	<a href="#">3808 10 17</a>	<a href="#">3908 10 17</a>	19	17.5	37.5	31	0.083

The body swivels for positioning purposes.

These models enable compact connection for elbow outlets, thus allowing space saving.

# Stud Fittings

## 3808

### Stud Branch Tee, Male BSPT Thread



Stainless steel 316L, FKM

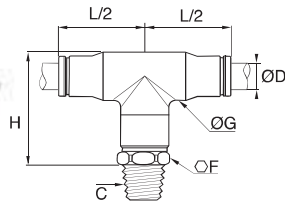

ØD	C		F	G	H	L/2	Kg
4	NPT1/8	<a href="#">3808 04 11</a>	11	10	22	19	0.026
6	NPT1/8	<a href="#">3808 06 11</a>	13	12.5	30	24	0.031
	NPT1/4	<a href="#">3808 06 14</a>	14	12.5	30	24	0.044
8	NPT1/8	<a href="#">3808 08 11</a>	14	15	34	25	0.042
	NPT1/4	<a href="#">3808 08 14</a>	14	15	34	25	0.054
10	NPT1/4	<a href="#">3808 10 14</a>	19	17.5	40	31	0.082
	NPT3/8	<a href="#">3808 10 18</a>	19	17.5	40	31	0.084

The body swivels for positioning purposes.

## 3898/3998

### Stud Branch Tee, Male BSPP and Metric Thread



Stainless steel 316L, FKM

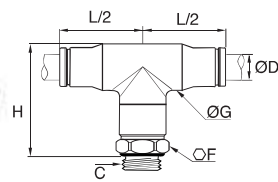

ØD	C			F	G	H	L/2	Kg
4	M5x0.8	<a href="#">3898 04 19</a>	<a href="#">3998 04 19</a>	10	11	27	19	0.024
	G1/8	<a href="#">3898 04 10</a>	<a href="#">3998 04 10</a>	13	11	27	19	0.026
	G1/4	<a href="#">3898 04 13</a>	<a href="#">3998 04 13</a>	17	11	27	19	0.032
6	M5x0.8	<a href="#">3898 06 19</a>	<a href="#">3998 06 19</a>	13	12	33.5	24	0.038
	G1/8	<a href="#">3898 06 10</a>	<a href="#">3998 06 10</a>	13	12	33	24	0.038
	G1/4	<a href="#">3898 06 13</a>	<a href="#">3998 06 13</a>	17	12	32	24	0.043
8	G1/8	<a href="#">3898 08 10</a>	<a href="#">3998 08 10</a>	14	15	35	25	0.051
	G1/4	<a href="#">3898 08 13</a>	<a href="#">3998 08 13</a>	17	15	35	25	0.053
	G3/8	<a href="#">3898 08 17</a>	<a href="#">3998 08 17</a>	21	15	34.5	25	0.058
10	G1/4	<a href="#">3898 10 13</a>	<a href="#">3998 10 13</a>	19	17	43	31	0.082
	G3/8	<a href="#">3898 10 17</a>	<a href="#">3998 10 17</a>	21	17	41	31	0.087

The body swivels for positioning purposes.

LF 3800 : 316L stainless steel (body) with 303 stainless steel collet, FKM seals  
 LF 3900 : full 316L, FKM seals



# Tube-to-Tube Fittings

## 3806/3906 Equal Straight Connector



Stainless steel 316L, FKM

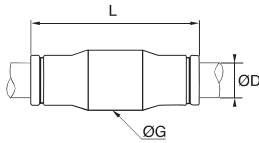

ØD			G	L	Kg
4	<a href="#">3806 04 00</a>	<a href="#">3906 04 00</a>	10	29	0.009
6	<a href="#">3806 06 00</a>	<a href="#">3906 06 00</a>	12	34	0.015
8	<a href="#">3806 08 00</a>	<a href="#">3906 08 00</a>	15	36	0.019
10	<a href="#">3806 10 00</a>	<a href="#">3906 10 00</a>	17.5	45	0.033
12	<a href="#">3806 12 00</a>	<a href="#">3906 12 00</a>	20	46.5	0.040

## 3806/3906 Equal Straight Connector



Stainless steel 316L, FKM

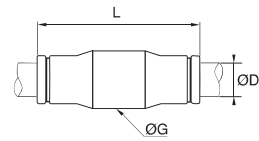

ØD			G	L	Kg
3/16	<a href="#">3806 55 00</a>	<a href="#">3906 55 00</a>	11	31	0.010
1/4	<a href="#">3806 56 00</a>	<a href="#">3906 56 00</a>	12	36	0.015
3/8	<a href="#">3806 60 00</a>	<a href="#">3906 60 00</a>	17	47	0.030
1/2	<a href="#">3806 62 00</a>	<a href="#">3906 62 00</a>	20	48	0.039

5/32" (4 mm) and 5/16" (8 mm) also available

## 3802/3902 Equal Stud Elbow



Stainless steel 316L, FKM

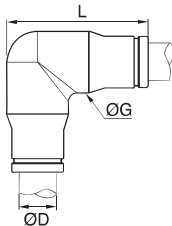

ØD			G	L	Kg
4	<a href="#">3802 04 00</a>	<a href="#">3902 04 00</a>	10	21.5	0.015
6	<a href="#">3802 06 00</a>	<a href="#">3902 06 00</a>	12	26.5	0.024
8	<a href="#">3802 08 00</a>	<a href="#">3902 08 00</a>	15	29.5	0.031
10	<a href="#">3802 10 00</a>	<a href="#">3902 10 00</a>	17.5	36.5	0.050
12	<a href="#">3802 12 00</a>	<a href="#">3902 12 00</a>	20	40	0.072

## 3802/3902 Equal Stud Elbow,



Stainless steel 316L, FKM

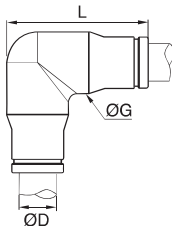

ØD			G	L	Kg
3/16	<a href="#">3802 55 00</a>	<a href="#">3902 55 00</a>	11	25	0.011
1/4	<a href="#">3802 56 00</a>	<a href="#">3902 56 00</a>	12	29	0.024
3/8	<a href="#">3802 60 00</a>	<a href="#">3902 60 00</a>	17	38	0.047
1/2	<a href="#">3802 62 00</a>	<a href="#">3902 62 00</a>	20	43	0.071

5/32" (4 mm) and 5/16" (8 mm) also available

## 3804/3904 Equal Tee



Stainless steel 316L, FKM

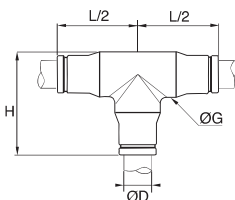

ØD			G	H	L/2	Kg
4	<a href="#">3804 04 00</a>	<a href="#">3904 04 00</a>	10	22	19	0.020
6	<a href="#">3804 06 00</a>	<a href="#">3904 06 00</a>	12	26	24	0.031
8	<a href="#">3804 08 00</a>	<a href="#">3904 08 00</a>	15	29.5	25	0.040
10	<a href="#">3804 10 00</a>	<a href="#">3904 10 00</a>	17.5	36.5	31	0.064
12	<a href="#">3804 12 00</a>	<a href="#">3904 12 00</a>	20	40	33	0.088

# Bulkhead Connector Fittings

## 3804/3904 Equal Tee



Stainless steel 316L, FKM

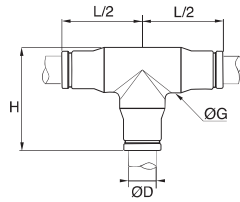

ØD			G	H	L/2	Kg
3/16	3804 55 00	3904 55 00	11	25	20	0.017
1/4	3804 56 00	3904 56 00	12	30	23	0.031
3/8	3804 60 00	3904 60 00	17	38	29	0.059
1/2	3804 62 00	3904 62 00	20	43	33	0.089

5/32" (4 mm) and 5/16" (8 mm) also available

## 3816/3916 Equal Bulkhead Connector



Stainless steel 316L, FKM

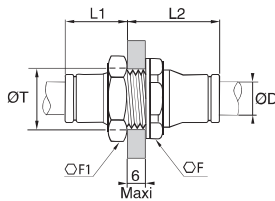

ØD			F	F1	L1	L2	ØT	Kg
4	3816 04 00	3916 04 00	13	14	13.5	19.5	13	0.017
6	3816 06 00	3916 06 00	17	17	16.5	21.5	14	0.027
8	3816 08 00	3916 08 00	19	19	18	24	16	0.034
10	3816 10 00	3916 10 00	22	22	21.5	27.5	21	0.049
12	3816 12 00	3916 12 00	24	24	24	29	23	0.059

IP55 sealing

## 3816/3916 Equal Bulkhead Connector



Stainless steel 316L, FKM

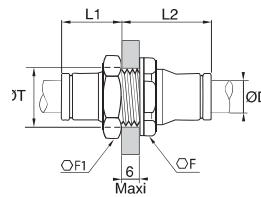

ØD			F	F1	L1	L2	ØT	Kg
3/16	3816 55 00	3916 55 00	17	13	15	18	12.5	0.017
1/4	3816 56 00	3916 56 00	19	17	19	21	15	0.026
3/8	3816 60 00	3916 60 00	22	22	22	27	21	0.052
1/2	3816 62 00	3916 62 00	27	27	25	28	25	0.076

IP55 sealing

5/32" (4 mm) and 5/16" (8 mm) also available

LF 3800/LF 3900 push-in fittings allow connection with several types of Parker Legris tubing shown in Chapter 3 of this catalogue, "Technical Tubing and Hose":

- PFA tubing
- Fluoropolymer tubing
- Polyethylene tubing
- Semi-rigid polyamide and flexible Crystal polyurethane tubing

# Plug-In Fittings and Accessories

## 3866/3966 Push-In Reducer



Stainless steel 316L, FKM

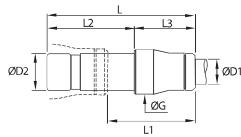

ØD1	ØD2			G	L	L1	L2	L3	Kg
4	6	<a href="#">3866 04 06</a>	<a href="#">3966 04 06</a>	10	35	19	19	16	0.009
	8	<a href="#">3866 04 08</a>	<a href="#">3966 04 08</a>	10	34	17	20	14	0.011
6	8	<a href="#">3866 06 08</a>	<a href="#">3966 06 08</a>	12	42	24	23	19	0.015
	10	<a href="#">3866 06 10</a>	<a href="#">3966 06 10</a>	12	41	19	25	16	0.019
8	10	<a href="#">3866 08 10</a>	<a href="#">3966 08 10</a>	15	45	22.5	25	20	0.020
	12	<a href="#">3866 08 12</a>	<a href="#">3966 08 12</a>	15	43	20	26	17	0.025
10	12	<a href="#">3866 10 12</a>	<a href="#">3966 10 12</a>	17	50	23	26	24	0.029

## 3826 Blanking Plug



Stainless steel 316L

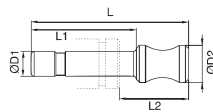

ØD1	ØD2		L	L1	L2	Kg
4	6	<a href="#">3826 04 00</a>	25	17	11	0.003
6	8	<a href="#">3826 06 00</a>	30.4	19.5	13.5	0.007
8	10	<a href="#">3826 08 00</a>	33	20	14	0.014
10	12	<a href="#">3826 10 00</a>	40	25	17	0.025
12	14	<a href="#">3826 12 00</a>	43	26	19	0.038

## 3800 Pre-Grooving Tool for Metallic Tubing

Treated steel

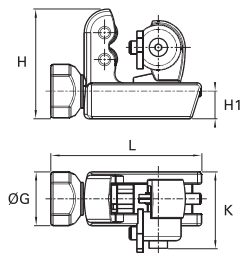

	G	H	H1	K	L	Kg
<a href="#">3800 70 00</a>	25	51	13	36	70	0.326

This tool correctly pre-grooves 4-12 mm O.D. and 3/16"-1/2" O.D. stainless steel tubing, to ensure that the LF 3800/LF 3900 collet grips the tube securely.

## 0605 Fluoropolymer Tape

FKM



	Kg
<a href="#">0605 12 12</a>	0.012

Can be used for temperatures from - 250°C to +260°C.  
Chemically inert and resistant to gases, acids, solvents, hydrocarbons, oils, alkalines, steam etc.  
Non-toxic, waterproof, self-lubricating.  
In accordance with CFR21.  
Can be used on all materials.  
Used to facilitate the preparation of leak-free threaded joints.  
Supplied on a reel, length = 12 m, width = 12.7 mm, thickness 0.08 mm.

## 3000 70 Dismounting Tool

Treated steel

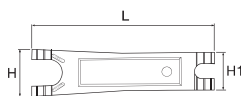

	H	H1	L	Kg
<a href="#">3000 70 00</a>	25	20	96	0.021

For dismantling LF 3000® tubing/fittings where access is difficult, we recommend the use of this dismounting tool.